

6701 Baymeadow Drive Glen Burnie, MD 21060

Suite B Floor Plan

Suite B

10,600 SF

- Finished ceiling height of 9'
- Abundant free onsite parking (ratio of 4.195/1,000 SF)
- Additional parking can be made available
- LED lighting throughout
- Primary electric service - 4,000 amps, 277/480 volt
- Suite separately metered for electricity
- UPS system and backup generator
- Loading docks available

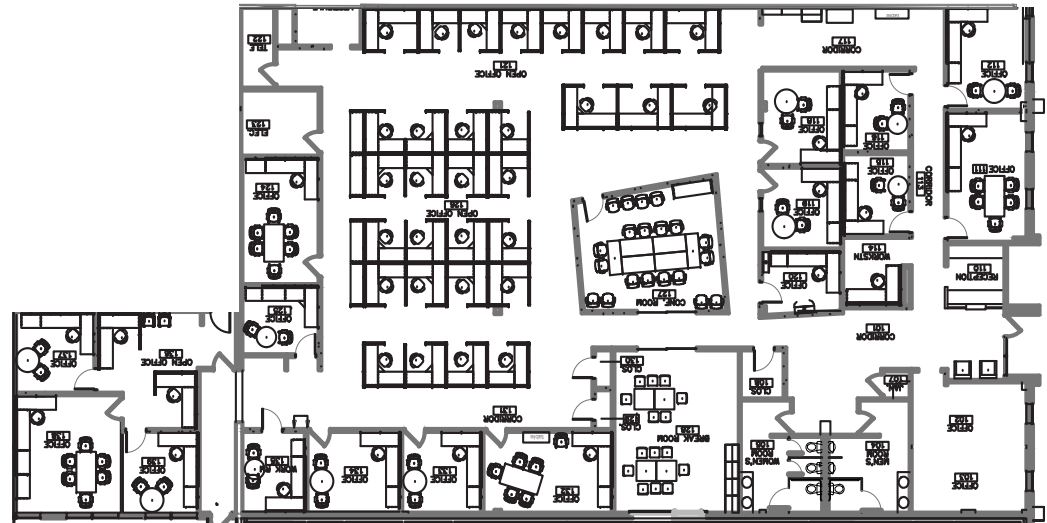

Contact Us

Thomas Gentner

Senior Vice President
+1 410 319 2407
tom.gentner@colliers.com

Brian Watts

Senior Vice President
+1 410 319 2408
brian.watts@colliers.com

Brian Siegel

Senior Vice President
+1 410 319 2410
brian.siegel@colliers.com

Jason Sullivan

Vice President
+1 410 319 2409
jason.sullivan@colliers.com

Colliers International

3600 Clipper Mill Road
Suite 105
Baltimore, MD 21211
P: +1 410 319 2411